

# TELESCOPIC ARM UMBRELLA

—  
Prostor P3  
Prostor P4  
—

Patented 'Easy Opening System'  
Telescopic arm 1,40 m up to 1,80 m  
Can swing horizontally  
Umbrella can tilt 10°



# Specifications and fixation

## DIMENSIONS

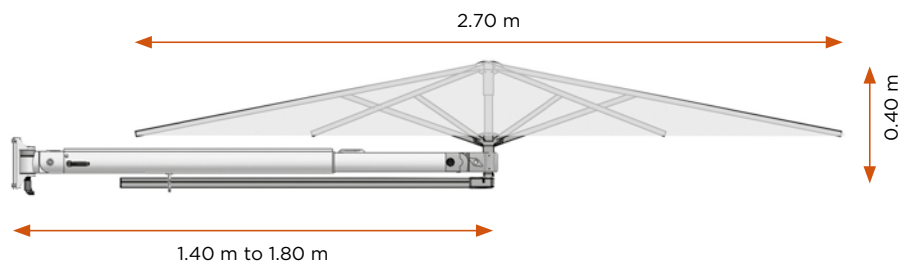

## FIXATION / WALL BRACKET

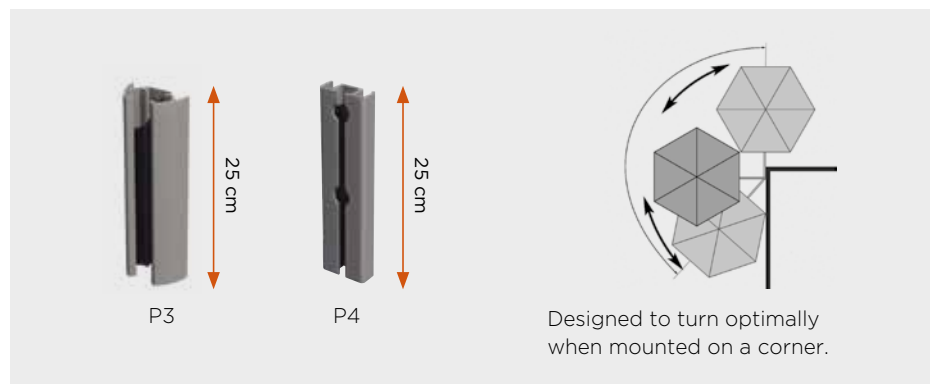

Prostor P3



Prostor P4

## Product video

Curious for more? Scan the QR code to view the product video on your smartphone or go to [www.prostor.be](http://www.prostor.be).

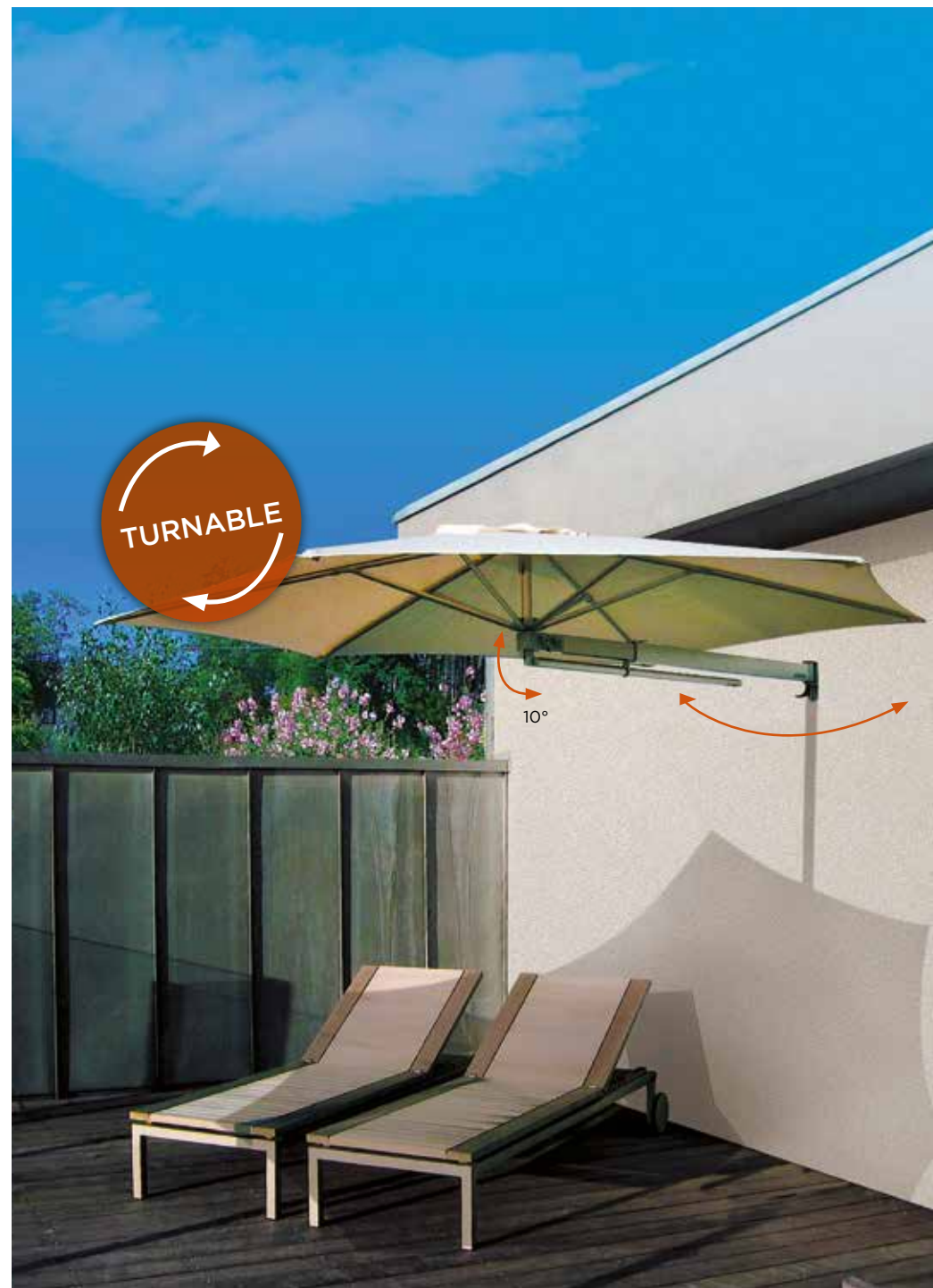

## User-friendly and easy operation



### P3 STRONG AND REMOVABLE!

- Can be easily removed from the wall bracket
- Can be locked in horizontal or vertical position
- Ideal for professional use (hotel, pub, restaurant,...)
- Weight of the arm: 4 kg

**STEP 1** Bring the arm horizontal (90°)

**STEP 2** Unfold the umbrella

**STEP 3** Open the umbrella

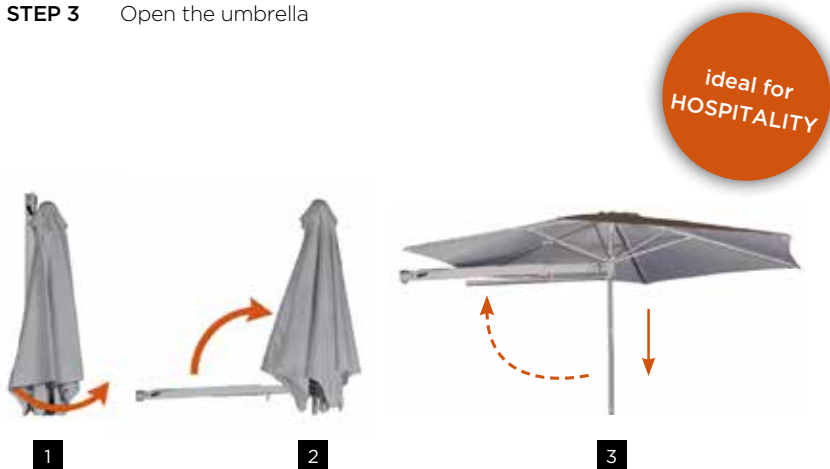

### P4 - EXTRA STEP TO IMPROVE YOUR COMFORT!

- User-friendly
- Can be locked in horizontal or vertical position or even at a 45° angle
- Standard with integrated gas spring to compensate the weight
- Weight of the arm: 4.75 kg

**STEP 1** Bring the arm to the 45° position

**STEP 2** Unfold the umbrella

**STEP 3** Bring the arm to the 90° position

**STEP 4** Open the umbrella

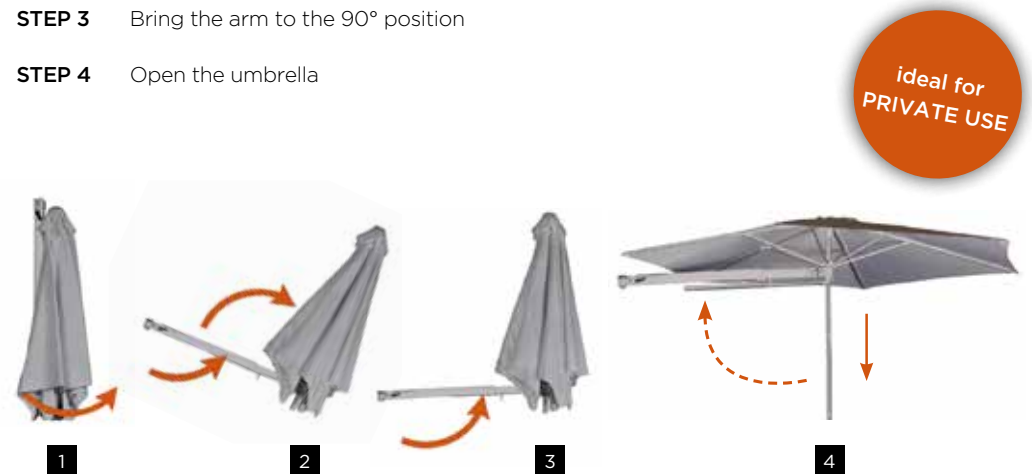



# FABRIC

## Add colour to your place in the shade

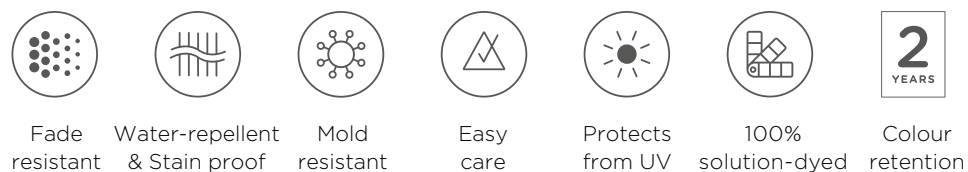
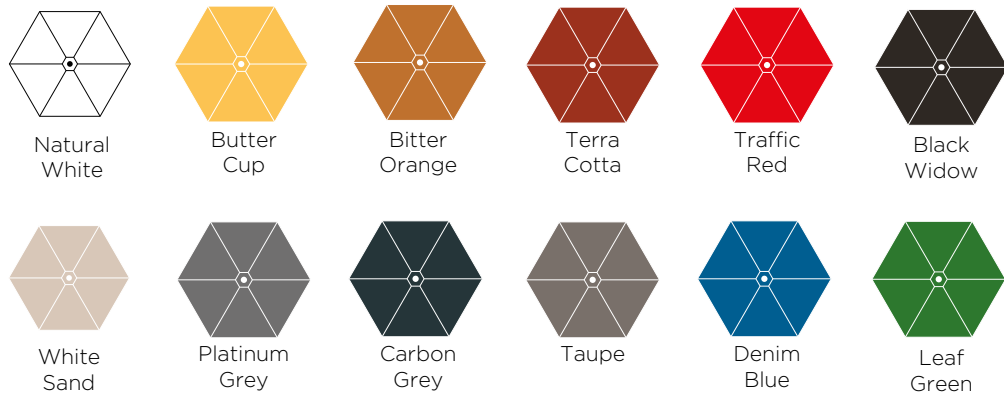

**100% Olefin** solution-dyed

**Weight:** 190 g/m<sup>2</sup>

**Colourfastness:** 7-8/8 (Standard ISO 105 B04)

**Water repellent**

**UV:** filters more than 97% of the UV rays

**Maintenance:** all fabrics can be washed and replaced.

**Arm and frame have a stylish finishing** in anodised aluminium.



100% recyclable



## Accessories

### Protection cover

**Protection cover** for 1 umbrella, allowing you to enjoy it even longer.



Standard